

*To arrange a viewing contact us
today on 01268 777400*

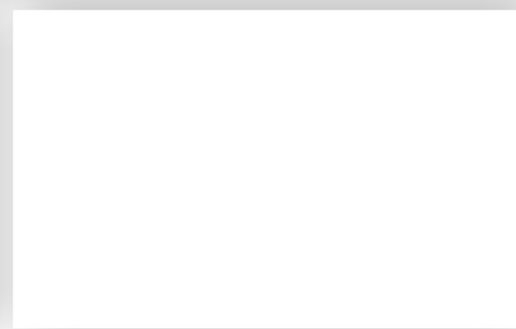
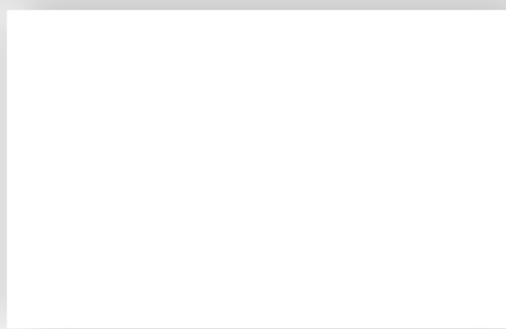

Cherry Tree Court Pound Lane Central, Basildon Guide price £270 000

Aspire Estate Agents Basildon are delighted to present this beautifully maintained top-floor two-bedroom apartment in the highly desirable Cherry Tree Court development (SS15). Offering style, space, and convenience, this modern home is perfect for first-time buyers, professionals, or investors seeking a move-in-ready property with a long lease and excellent location.

Overview

This stunning apartment boasts a bright, spacious layout with contemporary finishes throughout. The property benefits from two allocated parking spaces, a long lease of over 900 years, and Council Tax Band C, making it an attractive and secure long-term purchase.

Accommodation

Step through the entrance hall into a welcoming and well-designed interior.

The open-plan living, kitchen, and dining area forms the heart of the home — an elegant, L-shaped space with wood-effect flooring, spotlighting, and multiple double-glazed windows, including a charming bay window that fills the room with natural light.

The modern fitted kitchen includes an integrated oven, electric hob with extractor fan, ample wall and base units, and a central island ideal for dining or entertaining guests.

There are two well-proportioned bedrooms, including a generous master bedroom with built-in wardrobe space, and a contemporary family bathroom complete with a panel bath, shower attachment, vanity unit, and low-level W.C.

A separate utility room offers valuable space for laundry appliances and storage — a rare and practical feature for apartment living.

Externally

Residents benefit from two allocated parking spaces and access to a well-maintained communal garden, offering an inviting outdoor area without the upkeep of a private garden.

Location

Cherry Tree Court is ideally situated in a popular and well-connected area of Basildon, offering easy access to:

Laindon & Basildon Stations – quick links to London Fenchurch Street

A127 & M25 – excellent commuter road connections

Local shops, supermarkets, and cafés

Highly regarded schools and open green spaces

GROUND FLOOR

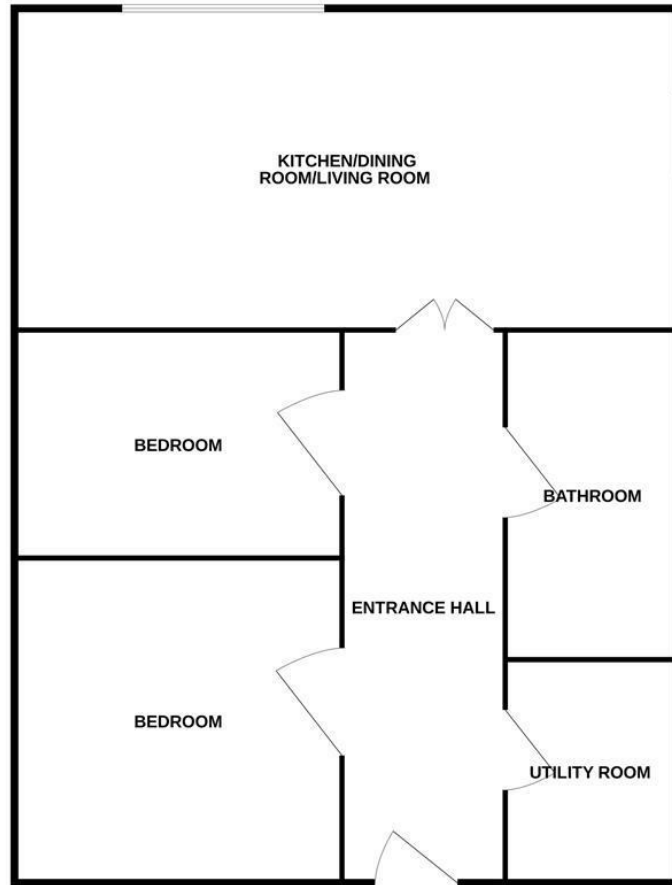

Whilst every attempt has been made to ensure the accuracy of the floorplan contained here, measurements of doors, windows, rooms and any other items are approximate and no responsibility is taken for any error, omission or mis-statement. This plan is for illustrative purposes only and should be used as such by any prospective purchaser. The services, systems and appliances shown have not been tested and no guarantee as to their operability or efficiency can be given.
Made with Metropix i2025

Energy Efficiency Rating		Current	Potential
Very energy efficient - lower running costs			
(92 plus) A		84	84
(81-91) B			
(69-80) C			
(55-68) D			
(39-54) E			
(21-38) F			
(1-20) G			
Not energy efficient - higher running costs			
England & Wales EU Directive 2002/91/EC			
Environmental Impact (CO ₂) Rating		Current	Potential
Very environmentally friendly - lower CO ₂ emissions			
(92 plus) A			
(81-91) B			
(69-80) C			
(55-68) D			
(39-54) E			
(21-38) F			
(1-20) G			
Not environmentally friendly - higher CO ₂ emissions			
England & Wales EU Directive 2002/91/EC			

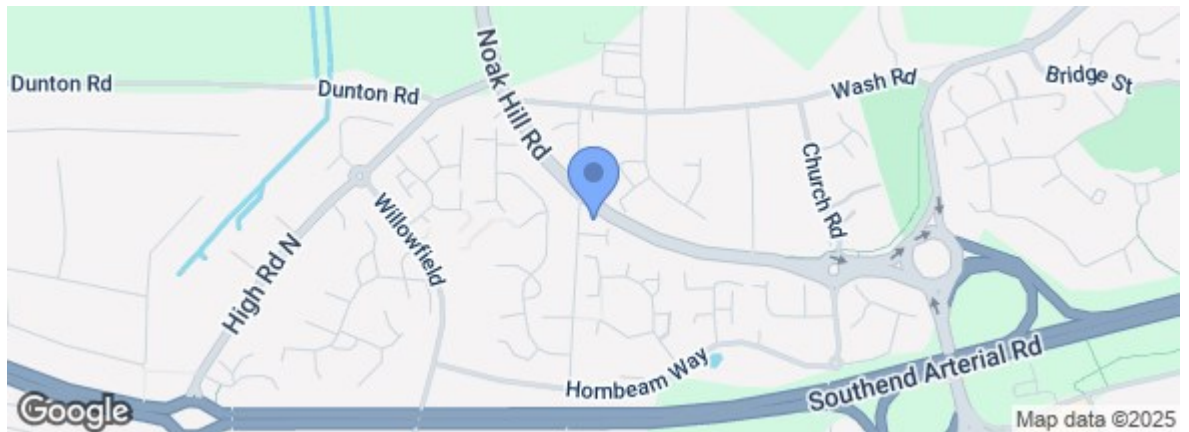

Under the Property Misdescriptions Act 1991 we make every effort to ensure our sales details are accurate but they are a general outline and do not constitute any part of an offer or contract. Any services, equipment and fittings have not been tested and no warranty can be given as to their condition. We strongly recommend that all the information provided be verified by your advisors and in particular, measurements required for a specific purpose such as fitted furniture or carpets. Please tell us if you have any problems and members of our branches will help either over the phone or in person. A copy of our complaints procedure is available on request. The details are issued on the strict understanding that any negotiations in respect of the property named herein are conducted through Aspire Estate Agents.